

MANUAL CM-09/10(Q)MC

AC mechanical tubular motors with wired operation

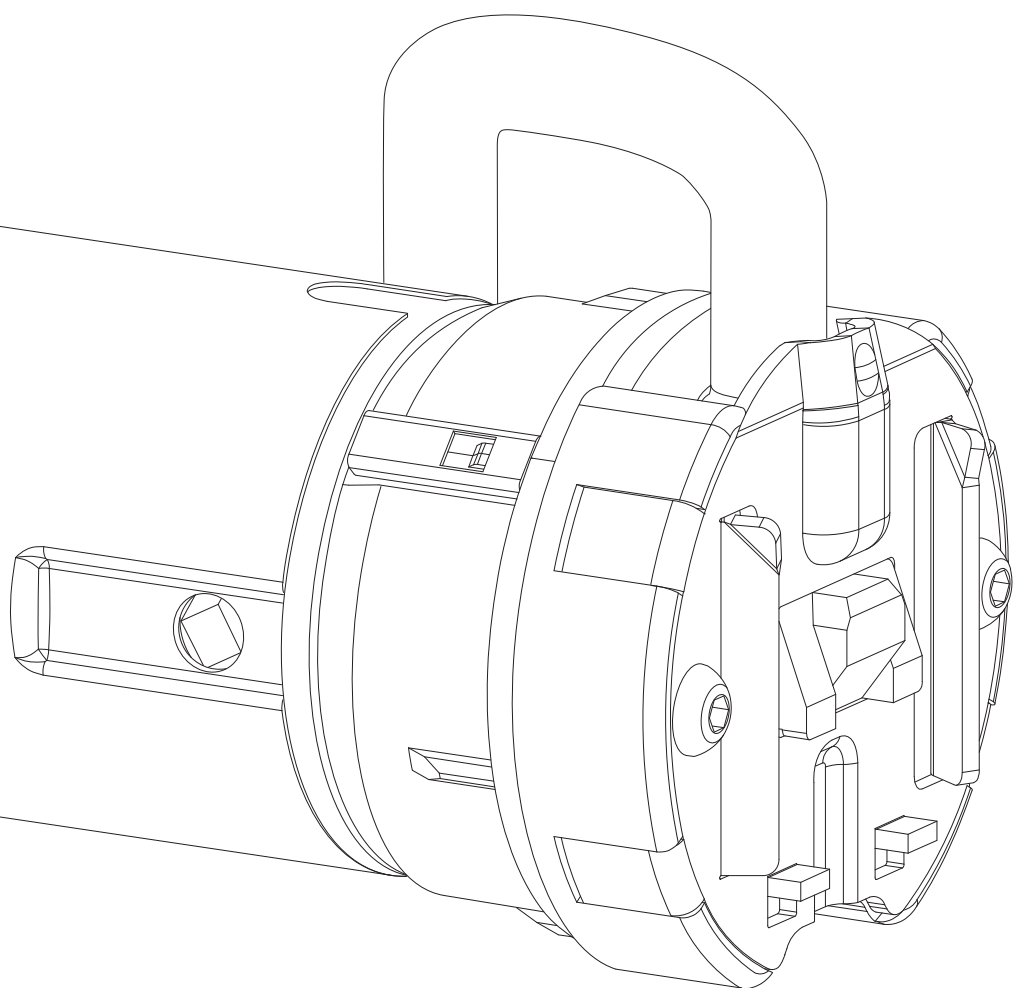

MOTION

CM-09/10(Q)MC
AC mechanical tubular motors with wired operation

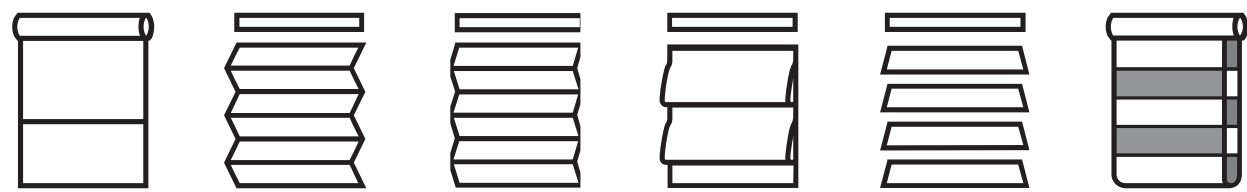

Motor features



AC Motor

Alternating current
motor

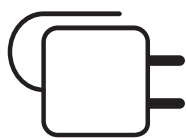

120V/230V

Powered by
120V/230V mains
electricity



Heavy duty

For heavy
application



Silent

Low noise motor

Control options



Wired Control

Operation with
wired switches

Support

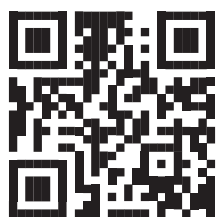

Video

How to install,
program and operate
rtube.nl/red1032

WARNING

Read the instructions carefully before assembling and using the product. Assembly can be completed by non-professionals. For indoor use only.

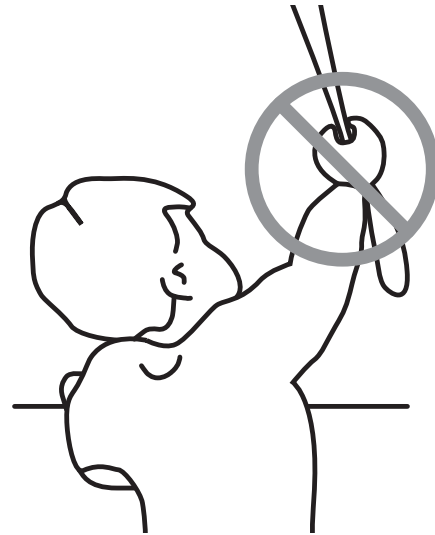

- Young children can strangle themselves with the loop of pull cords, chains and tapes, and cords that operate window coverings.
- To avoid strangulation and entanglement, keep cords out of reach of young children.
- Cords may ensnare a child's neck.
- Move beds, cots and furniture away from window covering cords.
- Do not tie cords together.
- Make sure cords do not twist together and form a loop.

Cleaning

Follow these general rules when cleaning the outside of the device and its components:

- Use a damp, soft, lint-free cloth. Avoid getting moisture in openings.
- Do not use aerosol sprays, solvents, alcohol, or abrasives.

Service & Support

Do not perform repairs yourself. Do not attempt to open the device or disassemble it. You run the risk of electric shock and voiding the limited warranty. No user-serviceable parts are inside.

Warranty Service

First follow the advice in this manual. If the product appears to be damaged or does not function properly, go to your local dealer for instructions on how to obtain warranty service.

Recycle

This marking indicates that this product should not be disposed with other household wastes throughout the EU. To prevent possible harm to the environment or human health from uncontrolled waste disposal, recycle it responsibly to promote the sustainable reuse of material resources. To return your used device, please use the return and collection systems or contact the retailer where the product was purchased. They can take this product for environmental safe recycling.



IP 44



Conforms to
UL Std. 325
Certified to
CSA Std. C22.2#247

1 Connecting diagram



IMPORTANT:
When the mains cable is permanently connected, a readily accessible disconnect device must be incorporated externally to the motor.

When there is a pluggable connector installed on the mains cable, the socket-outlet must be installed near the motor and shall be easily accessible.



- 1. Do not wire two or more motors to one single pole switch or relay.
- 2. Do not control one motor from several locations without using a proper controller.
- 3. Do not connect the brown wire and the black wire at the same time to the powersource, this may permanently damage the motor.

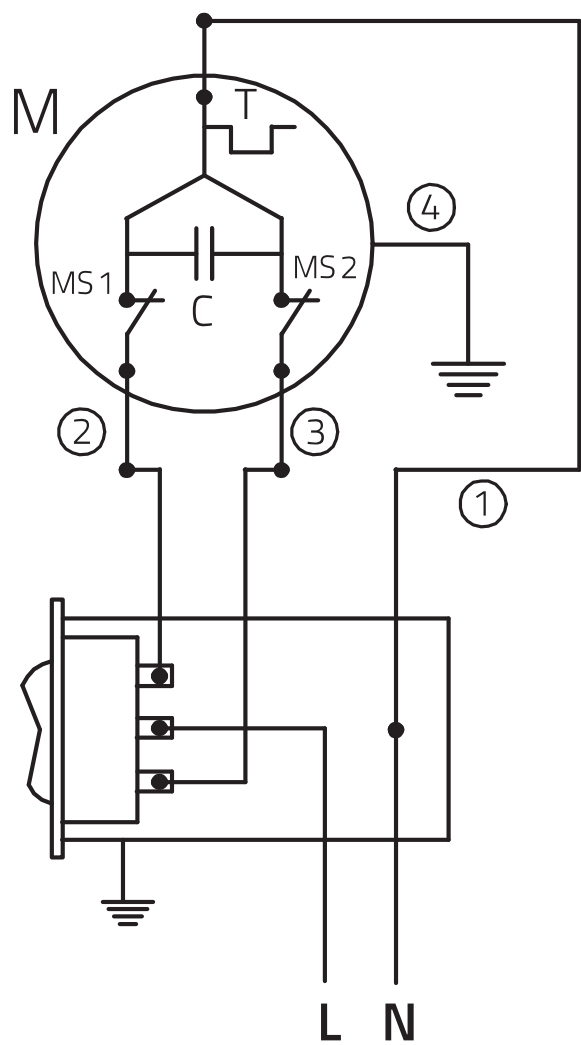

Mains Cable	230V	120V
Neutral (1)	Blue	White
Direction 1 (2)	Brown	Red
Direction 2 (3)	Black	Black
Ground (4)	Green/Yellow	Green

2 Find the adjuster screws on your blind

i Roller blind

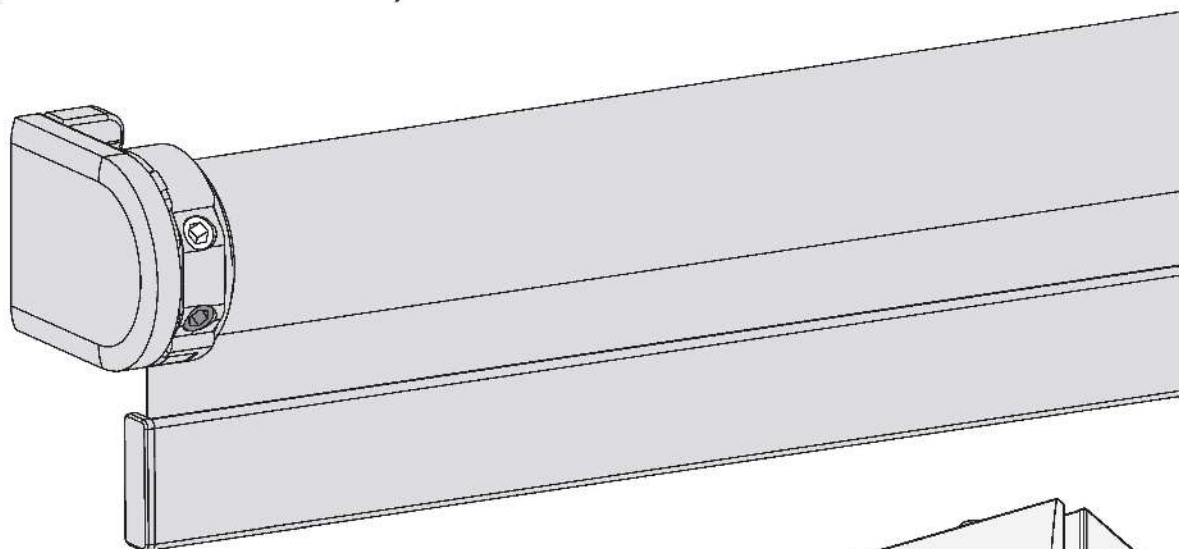

i Venetian blind

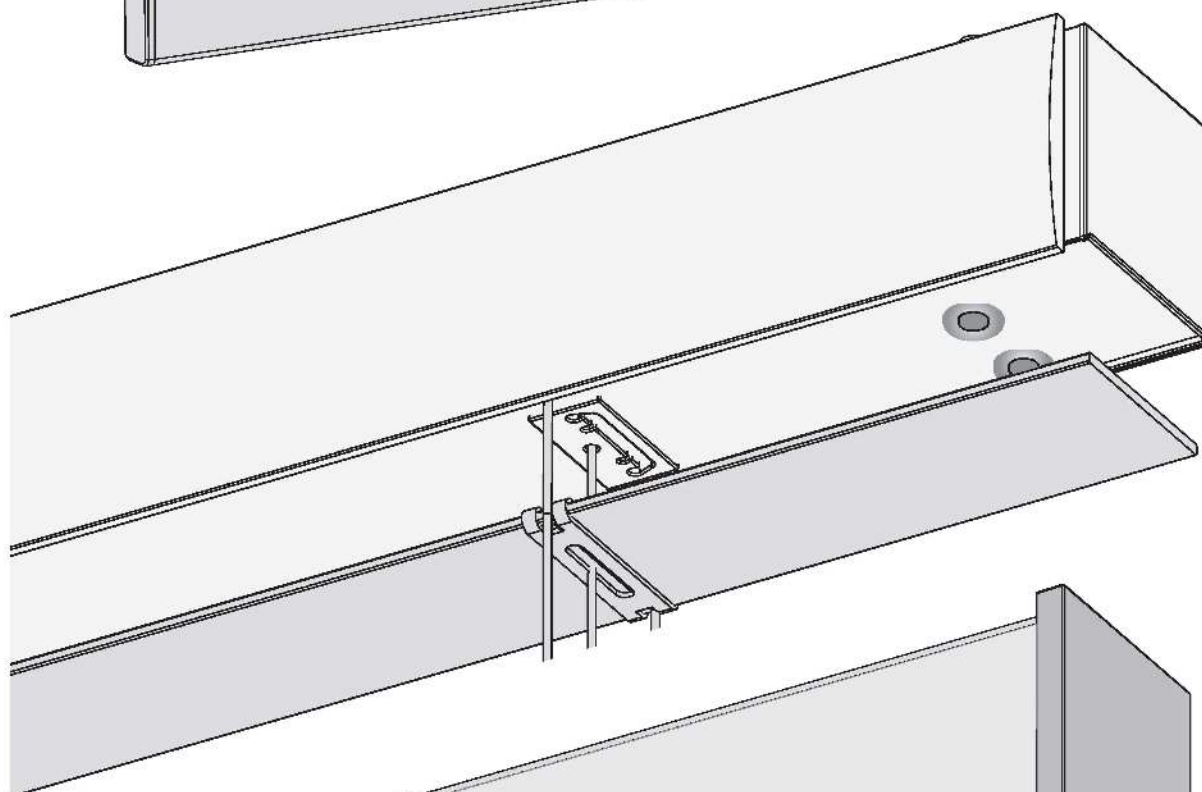

i Roman blind

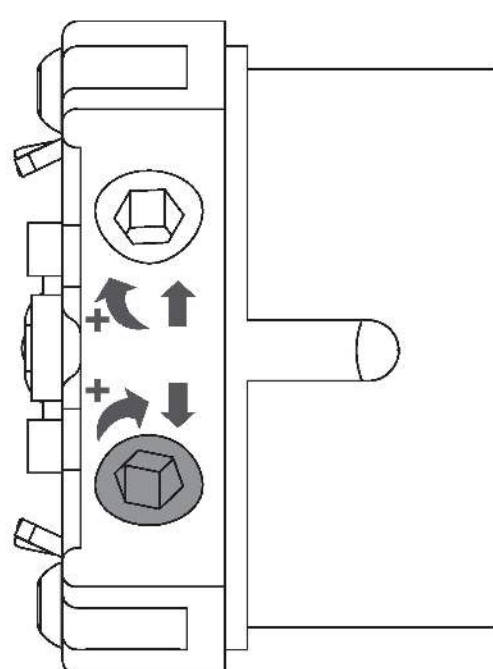
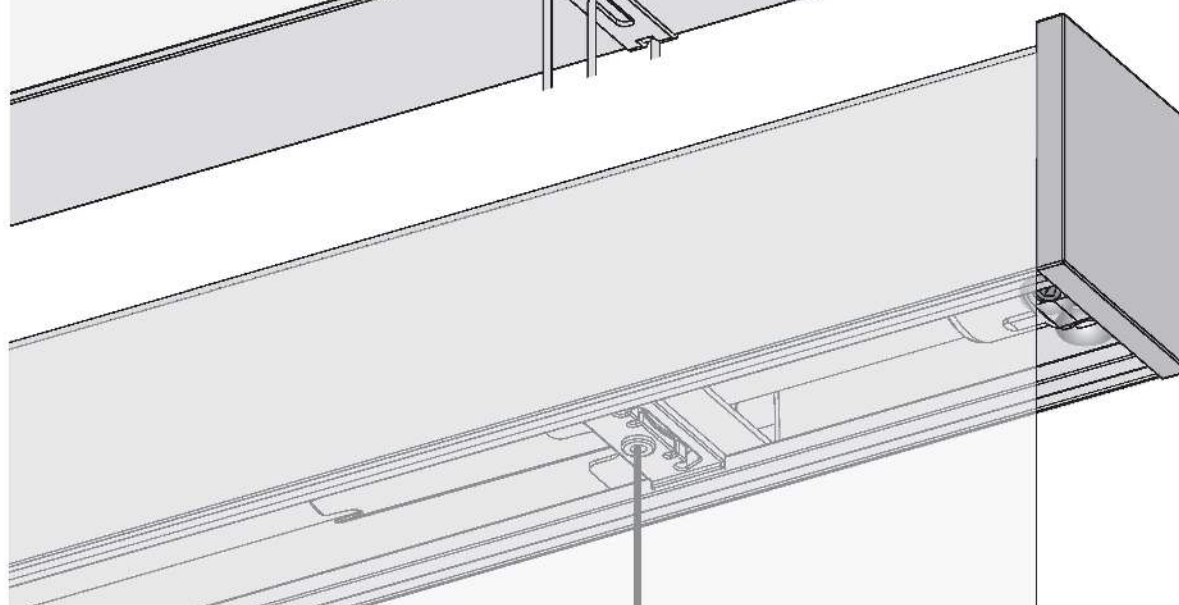

White adjuster screw

Red adjuster screw

i By turning the red or the white adjuster screw to the right (+) or to the left you can respectively enlarge the end position or make it smaller.

3 Set bottom position

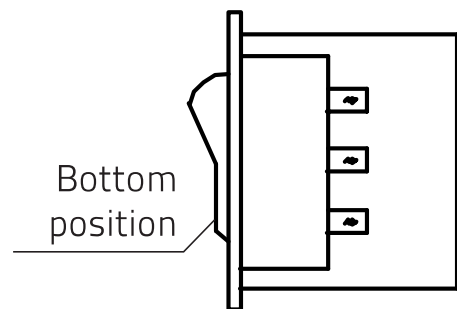
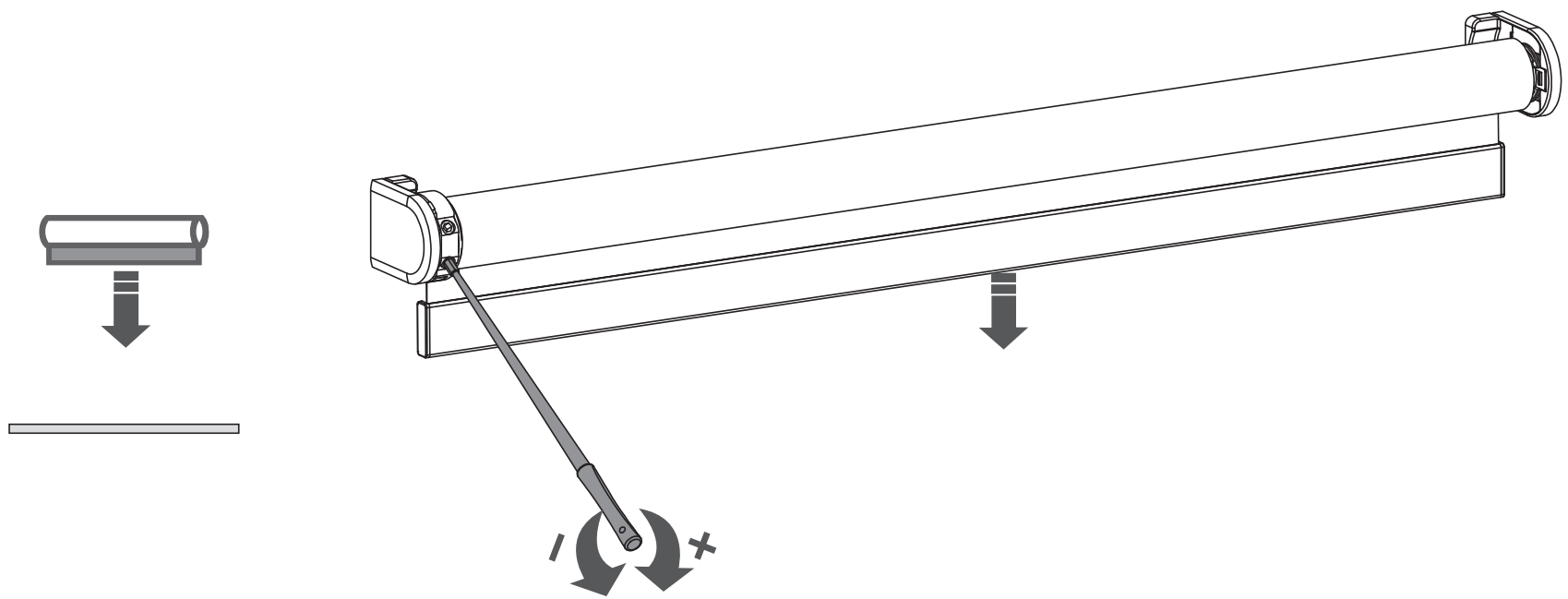

- 3.1 Turn the switch downwards and turn the white or red screw until the blind has reached the bottom position (select the white or red screw depending on the position of the motor in the blind; you need to first test this in order to make the selection). (Do not use a drill to adjust the limits).

4

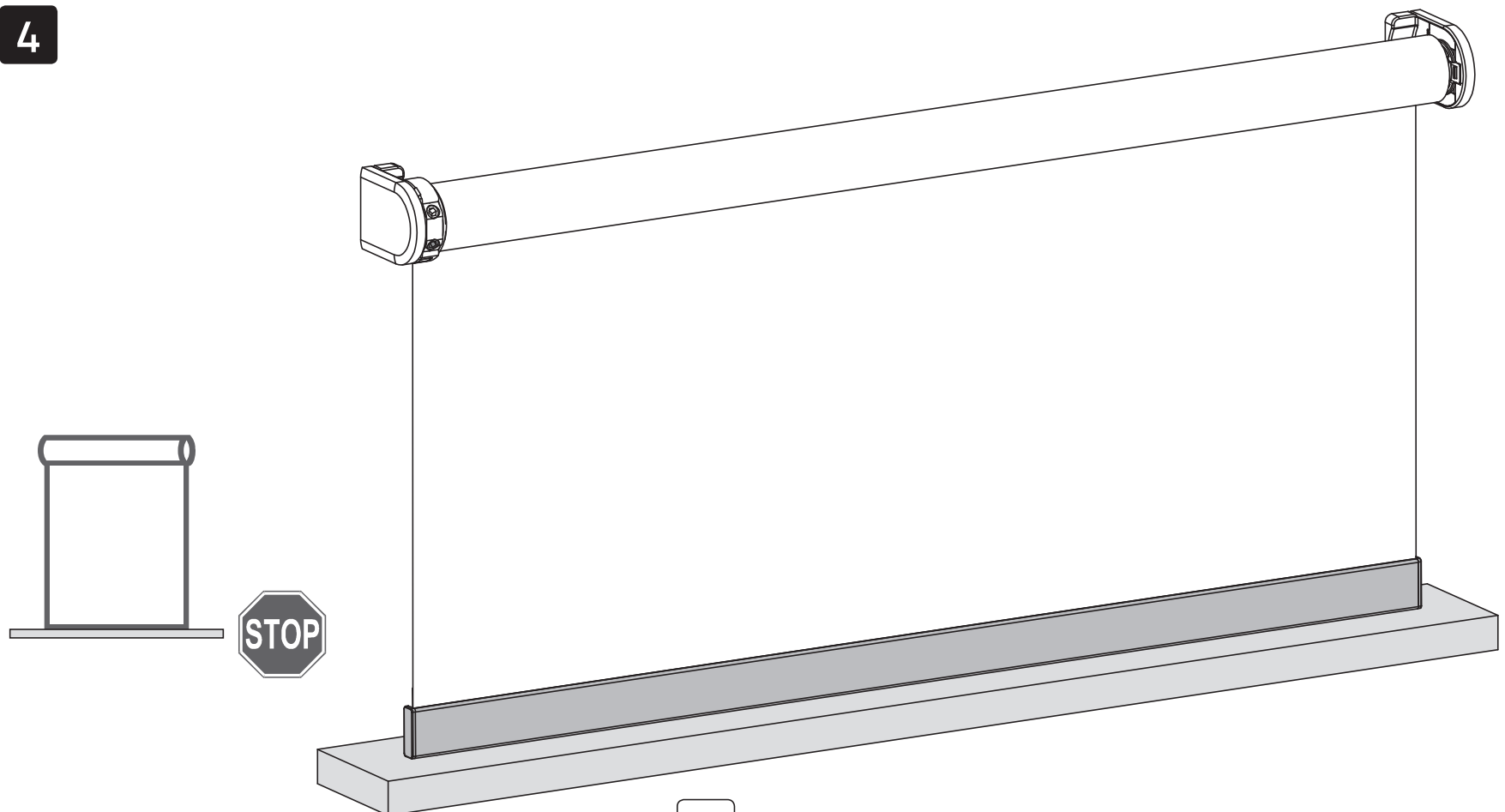

- 4.1 The bottom position is now set.

5 Set top position

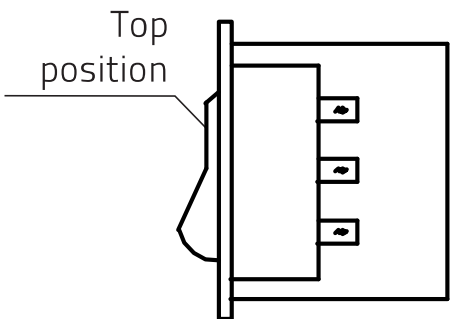
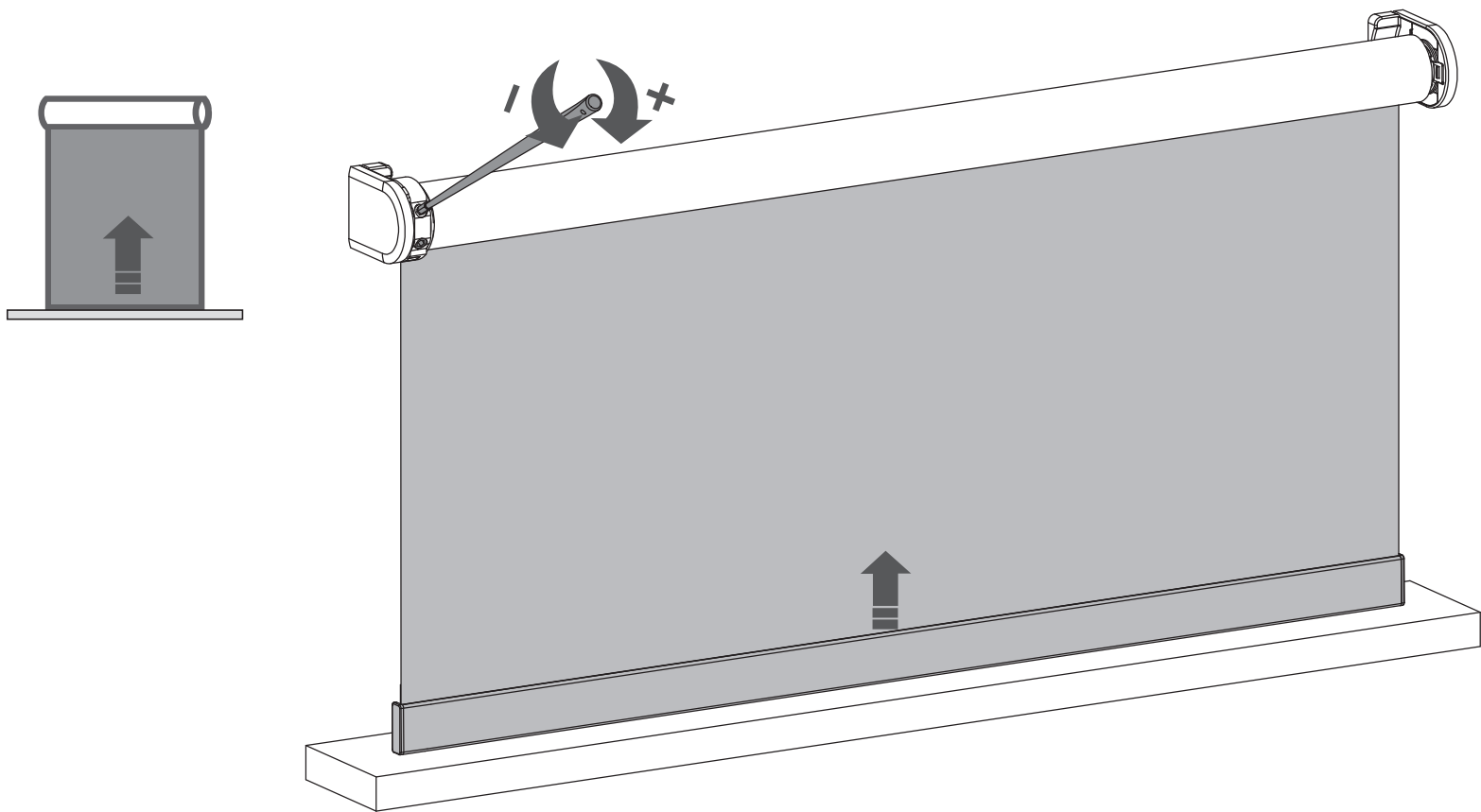

5.1 Turn the switch upwards and turn the white or red screw until the blind has reached the top position (select the white or red screw depending on the position of the motor in the blind; you need to first test this in order to make the selection). (Do not use a drill to adjust the limits).

6

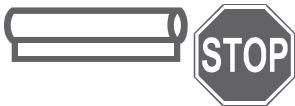
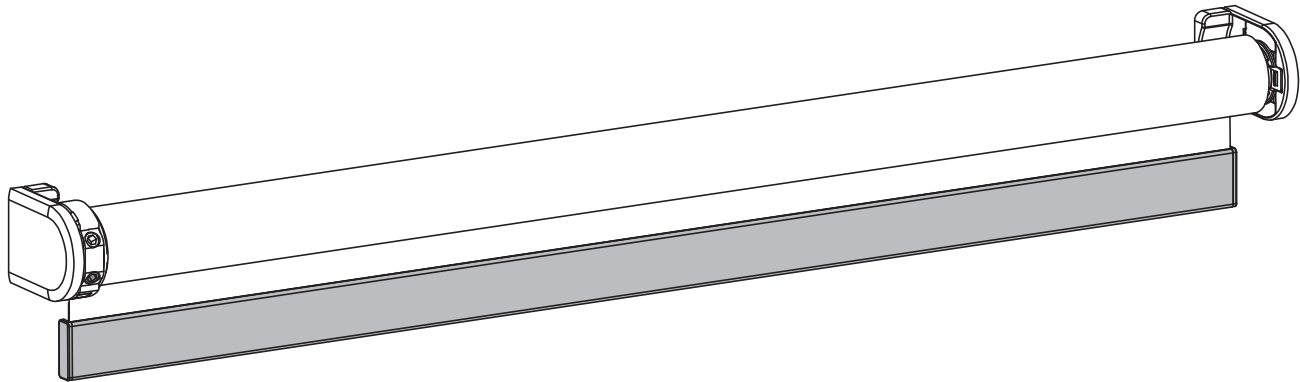

6.1 The top position is now set.

Frequently Asked Questions

Problem	Cause	Solution
Blind does not work.	Power supply is not connected.	Connect the wiring according to step 1.
	The motor is overheated.	Wait until the motor is cooled down.
Blind is stepping.	Two motors are connected to the same switch.	Use separate switches for separate motors.
Blind lowers too far.	End limits are set incorrect.	Set end limits. See step 3 - 6.
Blind moves in the opposite direction	The direction of rotation has been set incorrect.	Change the direction cables on the switch.

For the latest information and updated
manuals visit rtube.nl/cm-09mc

Disclaimer:

© Copyright Coulisse

All rights reserved. No part of this publication may be reproduced, stored in a retrieval system, or transmitted, in any form, by any means, electronic, mechanical, photocopying, recording, digital or otherwise without the written permission of the publisher.

Although this manual has been composed with the utmost care, Coulisse B.V. does not accept any responsibility for damage due to mistakes and/or faults in this manual.

Coulisse B.V. reserves the right to revise the manual and to revise and/or change its content at any time, without obligation to notify any person or entity of such revisions or changes.

The most recent version replaces older versions of this manual. The most recent version is available at my.coulisse.com or by contacting your Coulisse contact person.

We invite you to send remarks and comments about this manual to Coulisse at manuals@coulisse.com.